

MERCUBUANA

LEGEND



NAMA PROYEK :
PERENCANAAN INTERIOR
SWISSBELL HOTEL

JUDUL GAMBAR :
LAYOUT FULL 2ND FLOOR
RESTAURANT

NAMA:
MARCIA CHRISYOLITA

NIM:
41715010040

**DOSEN
PEMBIMBING:**
YOHANES NUGROHO
UTOMO, Drs, M.ds

SKALA 1: 200

JUMLAH GAMBAR	NOMOR GAMBAR
NILAI	PARAF

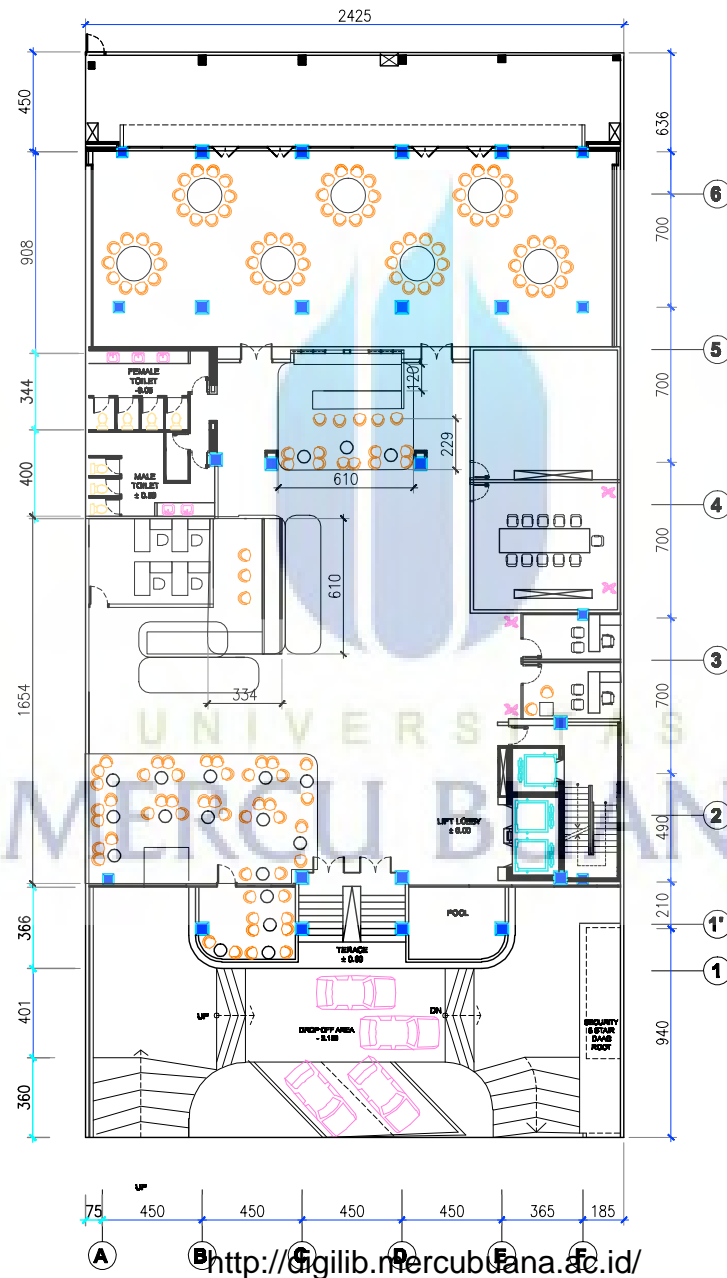

<http://digilib.mercubuana.ac.id/>

01 LAY OUT PLAN 1st FLOOR
SCALE 1:200

LEGEND



NAMA PROYEK :
PERENCANAAN INTERIOR
SWISSBELL HOTEL

JUDUL GAMBAR :
LAYOUT FULL 1ST FLOOR
LOBBY AREA

NAMA:
MARCIA CHRISYOLITA

NIM:
41715010040

DOSEN
PEMBIMBING:
YOHANES NUGROHO
UTOMO, Drs, M.ds

SKALA 1: 200

JUMLAH GAMBAR	NOMOR GAMBAR
NILAI	PARAF

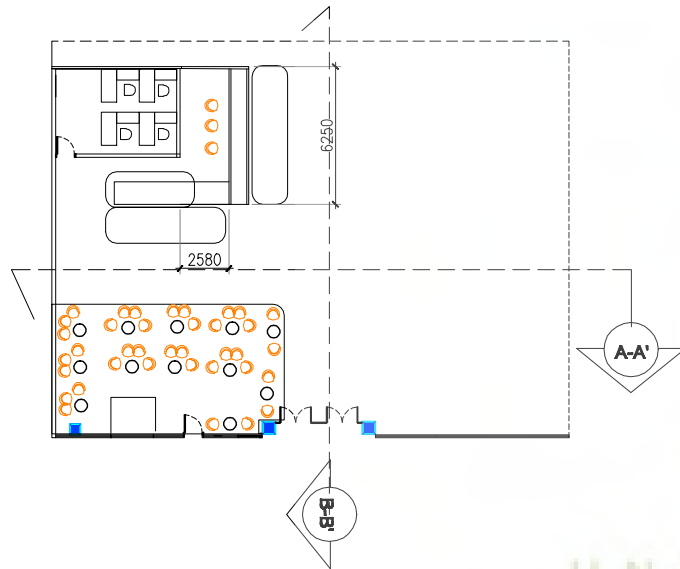

01 LAY OUT FURNITURE PLAN LOBBY
ID.SW.1 SCALE 1 : 100

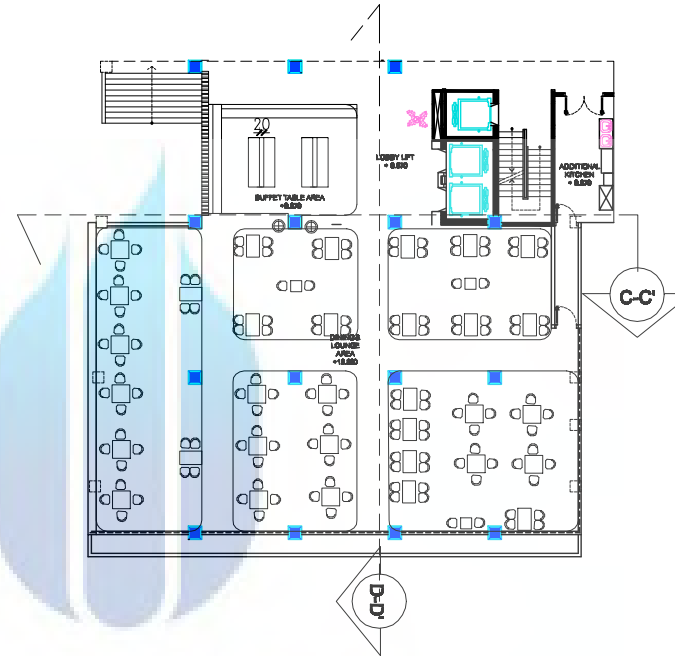
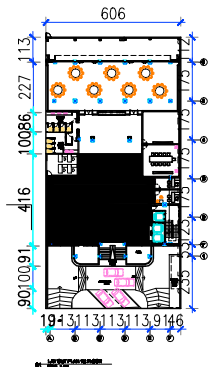

01 LAY OUT FLOOR PLAN LOBBY
ID.SW.2 SCALE 1 : 100

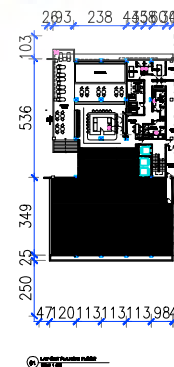

LEGEND



NAMA PROYEK :
PERENCANAAN INTERIOR
SWISSBELL HOTEL

JUDUL GAMBAR :
LAYOUT FURNITURE
(LOBBY&RESTO AREA)

NAMA:
MARCIA CHRISYOLITA

NIM:
41715010040

**DOSEN
PEMBIMBING:**
YOHANES NUGROHO
UTOMO, Drs, M.ds

SKALA 1: 100

JUMLAH GAMBAR **NOMOR GAMBAR**

2 GAMBAR **ID.SW.1**

ID.SW.2

NILAI

PARAF

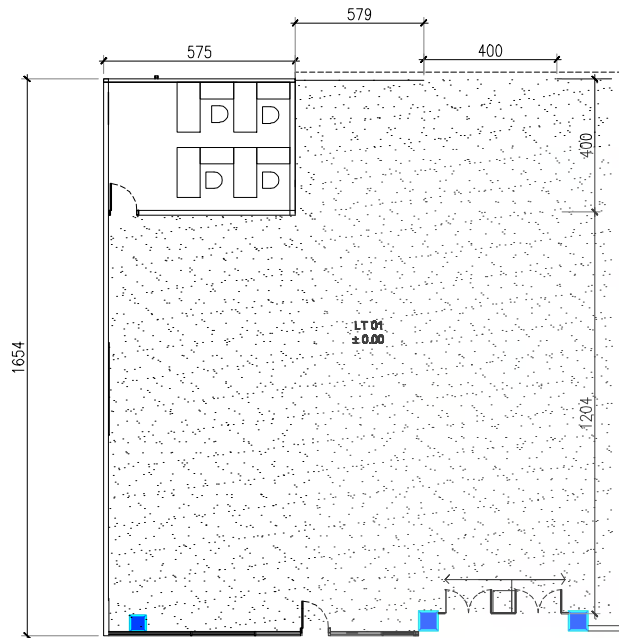

02 LAY OUT FLOOR PLAN LOBBY
ID.SW.1.1 SCALE 1 : 100

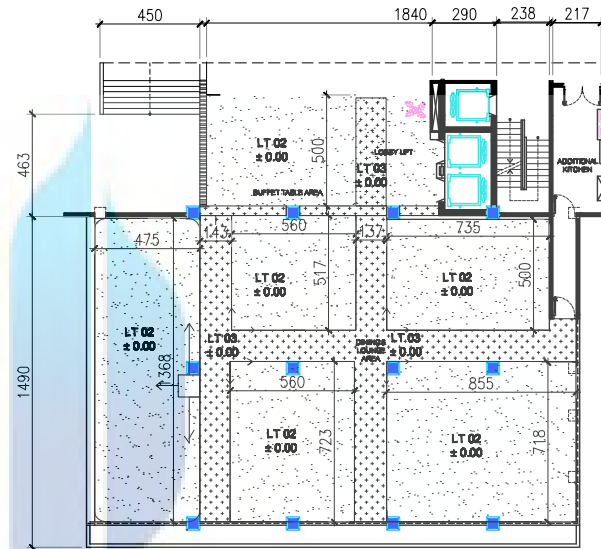
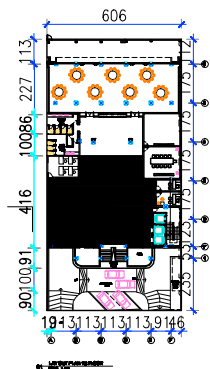

02 LAY OUT FLOOR PLAN RESTAURANT
ID.SW.2.1 SCALE 1 : 100

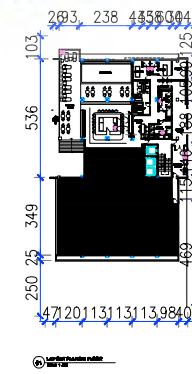

LEGEND

- LT 1 : Marmor Tile 1x1
- LT 2 : Marmor puth
- L 03 : Granite



NAMA PROYEK :
PERENCANAAN INTERIOR
SWISSBELL HOTEL

JUDUL GAMBAR :
FLOOR PLAN
(LOBBY & RESTAURAN
AREA)

NAMA:
MARCIA CHRISYOLITA

NIM:
41715010040

**DOSEN
PEMBIMBING:**
YOHANES NUGROHO
UTOMO, Drs, M.ds

SKALA 1: 100

JUMLAH GAMBAR	NOMOR GAMBAR
2 GAMBAR	ID.SW.1.1 ID.SW.2.1

NILAI **PARAF**

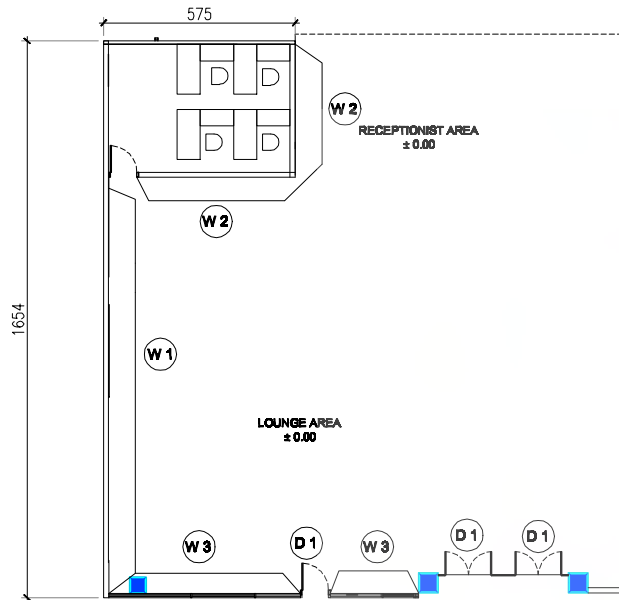

03 LAY OUT WALL PLAN LOBBY
ID.SW.1.2 SCALE 1 : 100

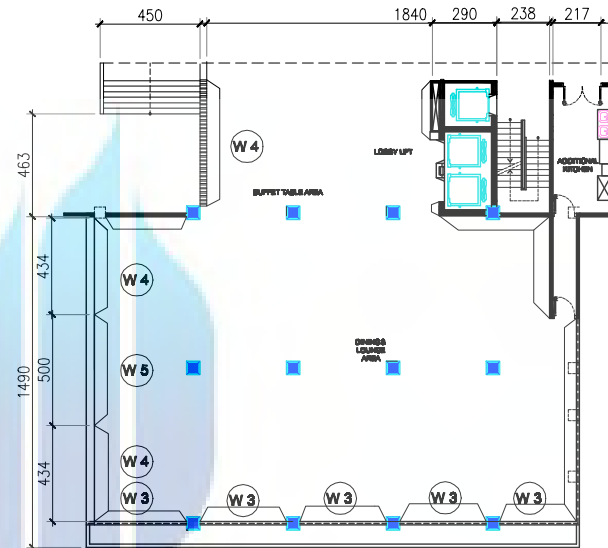
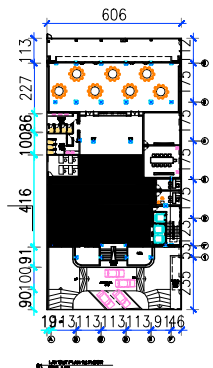

03 LAY OUT WALL PLAN RESTAURAN
ID.SW.2.2 SCALE 1 : 100

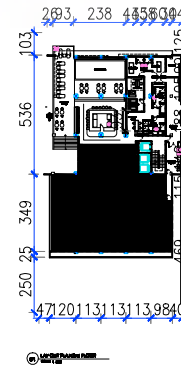

LEGEND

- W 1: Kaca Bronze silver motif garis keupat
- W 2: Kaca bronze gold motif garis
- W 3: Window Clear Glass
- W 4: Plywood finishing hpl, leveling
- W 5: Paint finished dulux dolphin grey 40700
- D 1 : Door Glass



NAMA PROYEK :
PERENCANAAN INTERIOR
SWISSBELL HOTEL

JUDUL GAMBAR :
WALL PLAN
(LOBBY & RESTAURANT
AREA)

NAMA:
MARCIA CHRISYOLITA

NIM:
41715010040

**DOSEN
PEMBIMBING:**
YOHANES NUGROHO
UTOMO, Drs, M.ds

SKALA 1: 100

JUMLAH GAMBAR	NOMOR GAMBAR
2 GAMBAR	ID.SW.1.2 ID.SW.2.2

NILAI **PARAF**

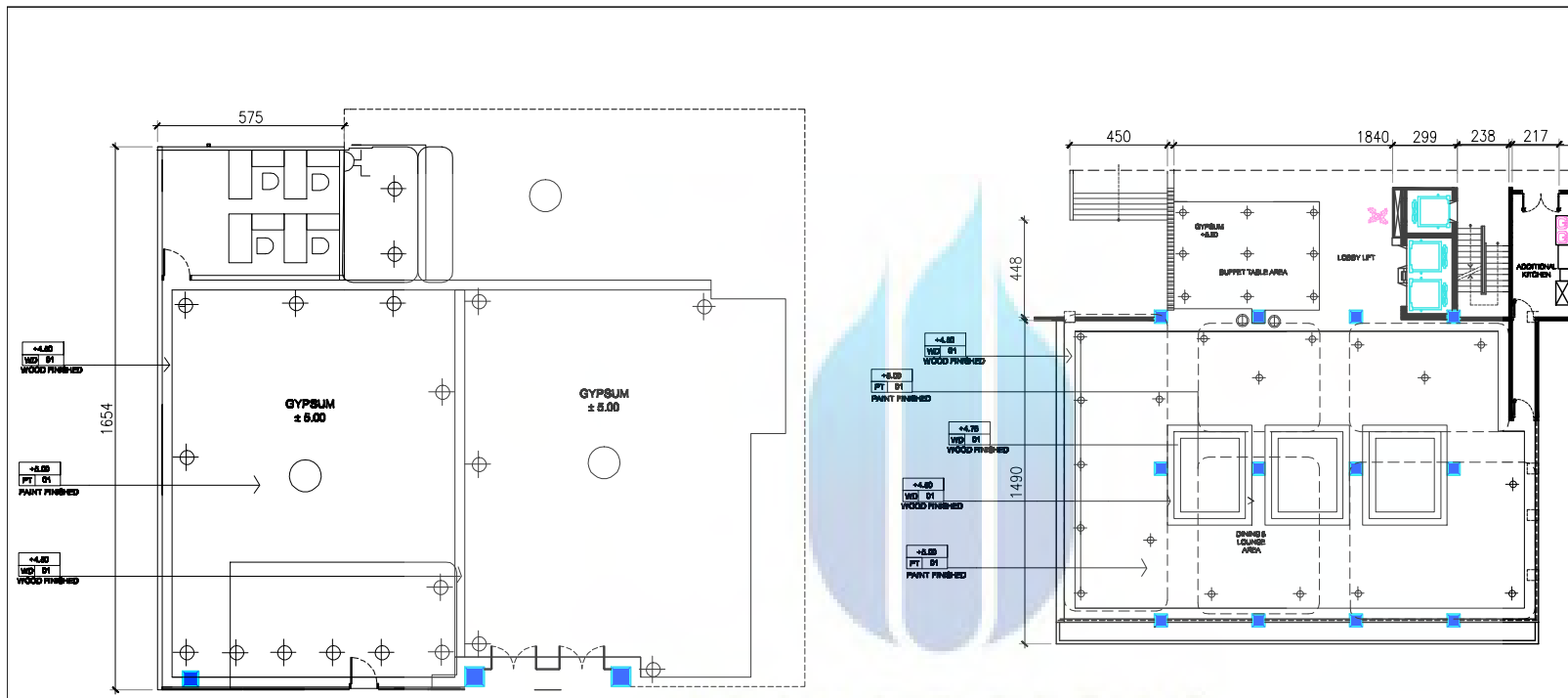

04 LAY OUT CEILING PLAN LOBBY
 D.SW.1.3 SCALE 1 : 100

04 LAY OUT CEILING PLAN RESTAURAN
 ID.SW.2.3 SCALE 1 : 100

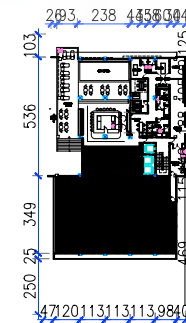
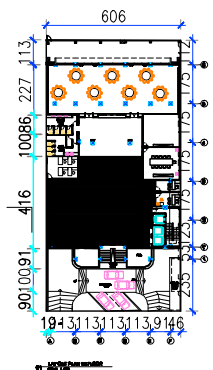

LEGEND

- ⊕ : Downlight 15 watt
- : Lampu gantung



NAMA PROYEK :
PERENCANAAN INTERIOR
SWISSBELL HOTEL

JUDUL GAMBAR :
CEILING PLAN
(LOBBY & RESTAURANT
AREA)

NAMA:
MARCIA CHRISYOLITA

NIM:
41715010040

DOSEN
PEMBIMBING:
YOHANES NUGROHO
UTOMO, Drs, M.ds

SKALA 1: 100

JUMLAH GAMBAR	NOMOR GAMBAR
2 GAMBAR	ID.SW.1.3
	ID.SW.2.3

NILAI **PARAF**

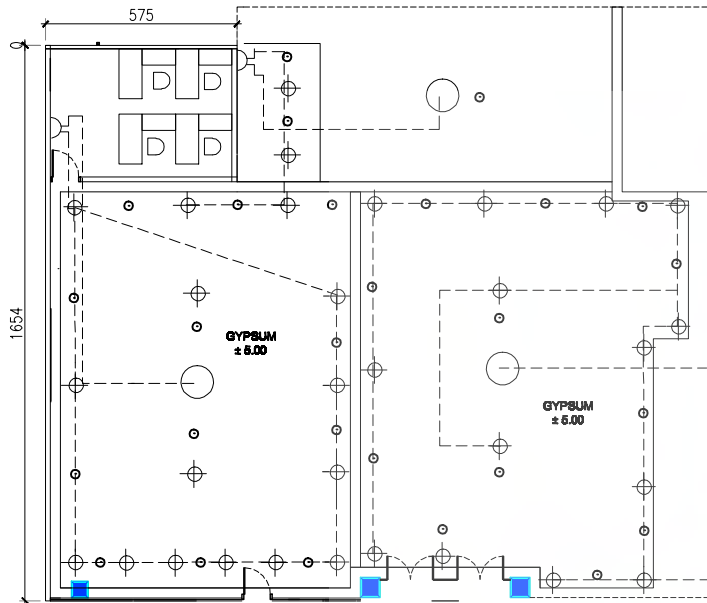

05 LAY OUT ME LOBBY
ID.SW.14 SCALE 1 : 100

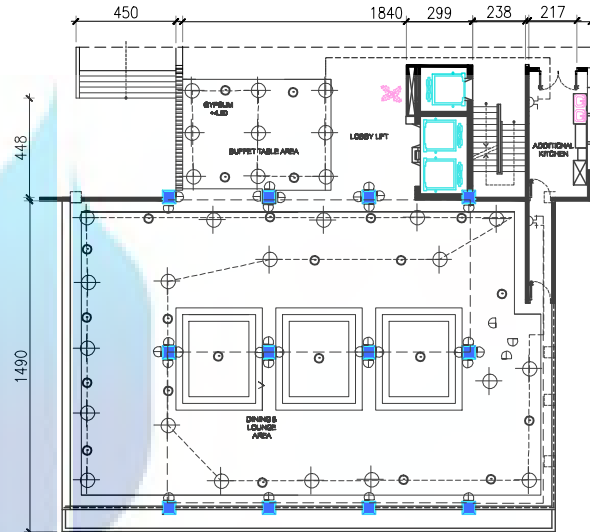

05 LAY OUT ME RESTAURAN
ID.SW.24 SCALE 1 : 100

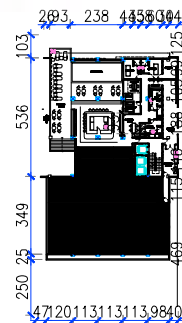
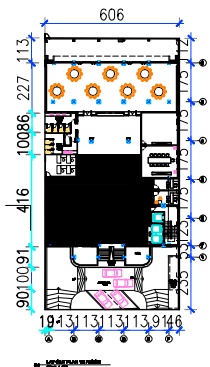

LEGEND

- ⊙ : Downlight 15 watt
- : Lampu gantung
- ⊙ : Sprinkler
- ⌋ : Saklar
- - - : Kabel



NAMA PROYEK :
PERENCANAAN INTERIOR
SWISSBEL HOTEL

JUDUL GAMBAR :
ME LAYOUT
(RESTAURANT & LOBBY
AREA)

NAMA:
MARCIA CHRISYOLITA

NIM:
41715010040

**DOSEN
PEMBIMBING:**
YOHANES NUGROHO
UTOMO, Drs, M.ds

SKALA 1: 100

JUMLAH GAMBAR	NOMOR GAMBAR
2 GAMBAR	ID.SW.1.4 ID.SW.2.4
NILAI	PARAF

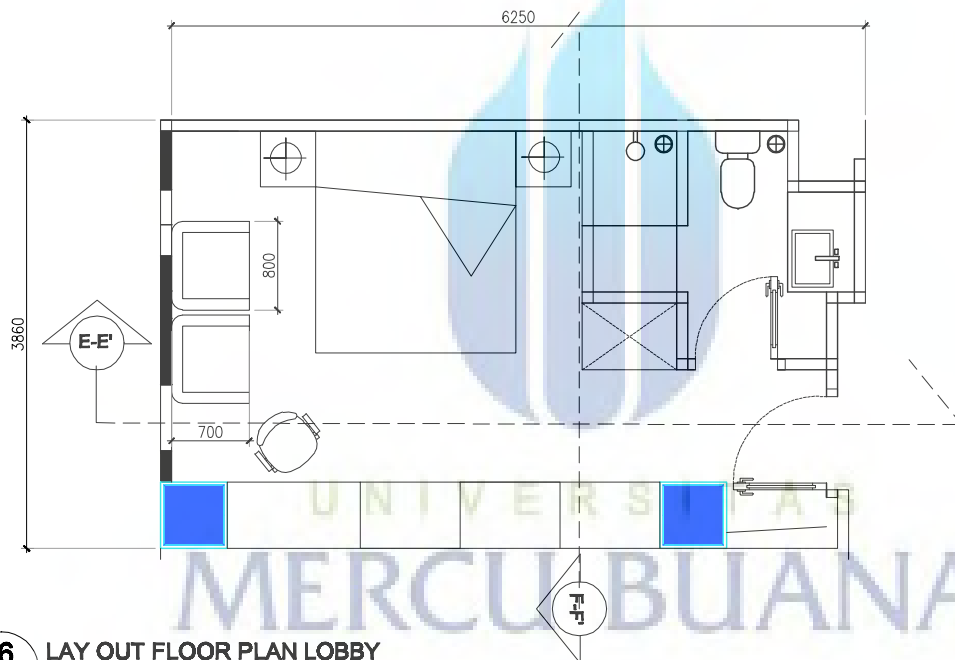

06 LAY OUT FLOOR PLAN LOBBY
 ID.SW.3 SCALE 1 : 100

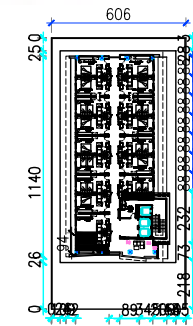

LEGEND



NAMA PROYEK :
 PERENCANAAN INTERIOR
 SWISSBELL HOTEL

JUDUL GAMBAR :
 LAYOUT FURNITURE
 (STANDAR ROOM)

NAMA:
 MARCIA CHRISYOLITA

NIM:
 41715010040

**DOSEN
 PEMBIMBING:**
 YOHANES NUGROHO
 UTOMO, Drs, M.ds

SKALA 1: 100

JUMLAH GAMBAR	NOMOR GAMBAR
---------------	--------------

1 GAMBAR	ID.SW.3
----------	---------

NILAI	PARAF
-------	-------

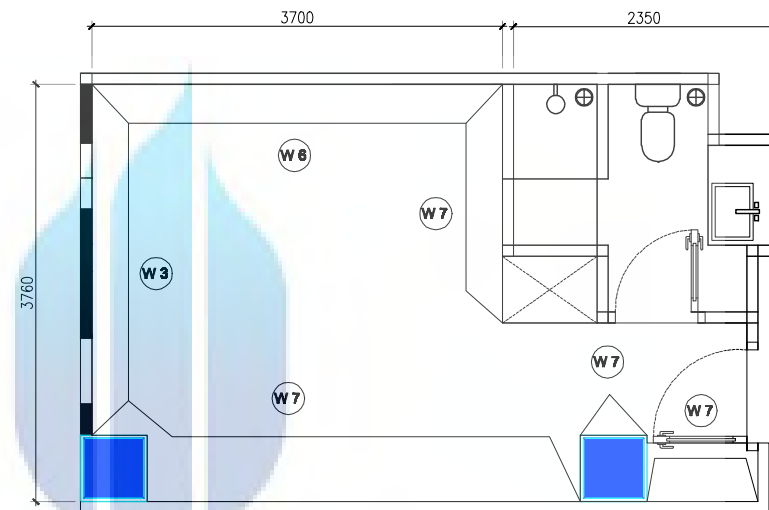
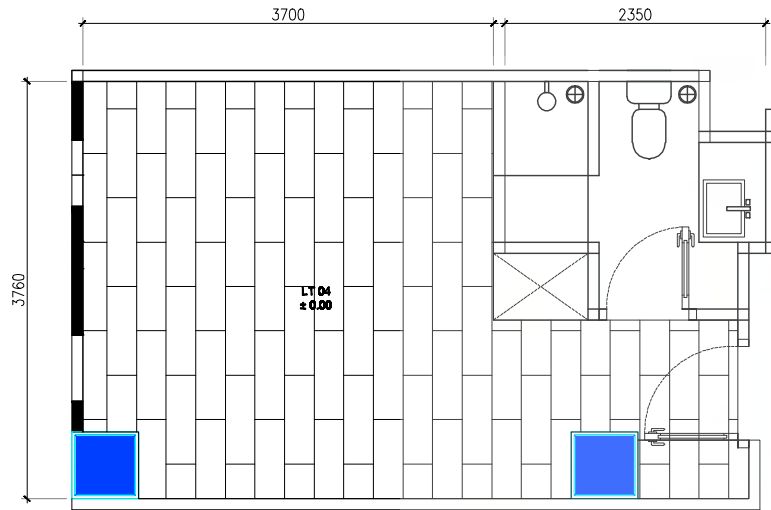

LEGEND	
L 04 : Lantai finishing vinyl	
W 6 : Plywood finishing hpl taco	
W 3 : Window Clear Glass	
W 7 : Paint finished dulux north grey 40701	
	
NAMA PROYEK : PERENCANAAN INTERIOR SWISSBELL HOTEL	
JUDUL GAMBAR : FLOOR PLAN & WALL PLAN (STANDAR ROOM)	
NAMA: MARCIA CHRISYOLITA	
NIM: 41715010040	
DOSEN PEMBIMBING: YOHANES NUGROHO UTOMO, Drs, M.ds	
SKALA 1: 100	
JUMLAH GAMBAR	NOMOR GAMBAR
2 GAMBAR	ID.SW.3.1 ID.SW.3.2
NILAI	PARAF

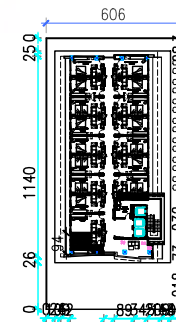
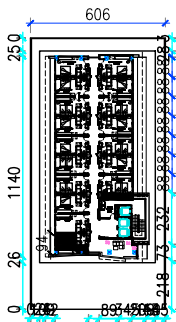

UNIVERSITAS
MERCU BUANA

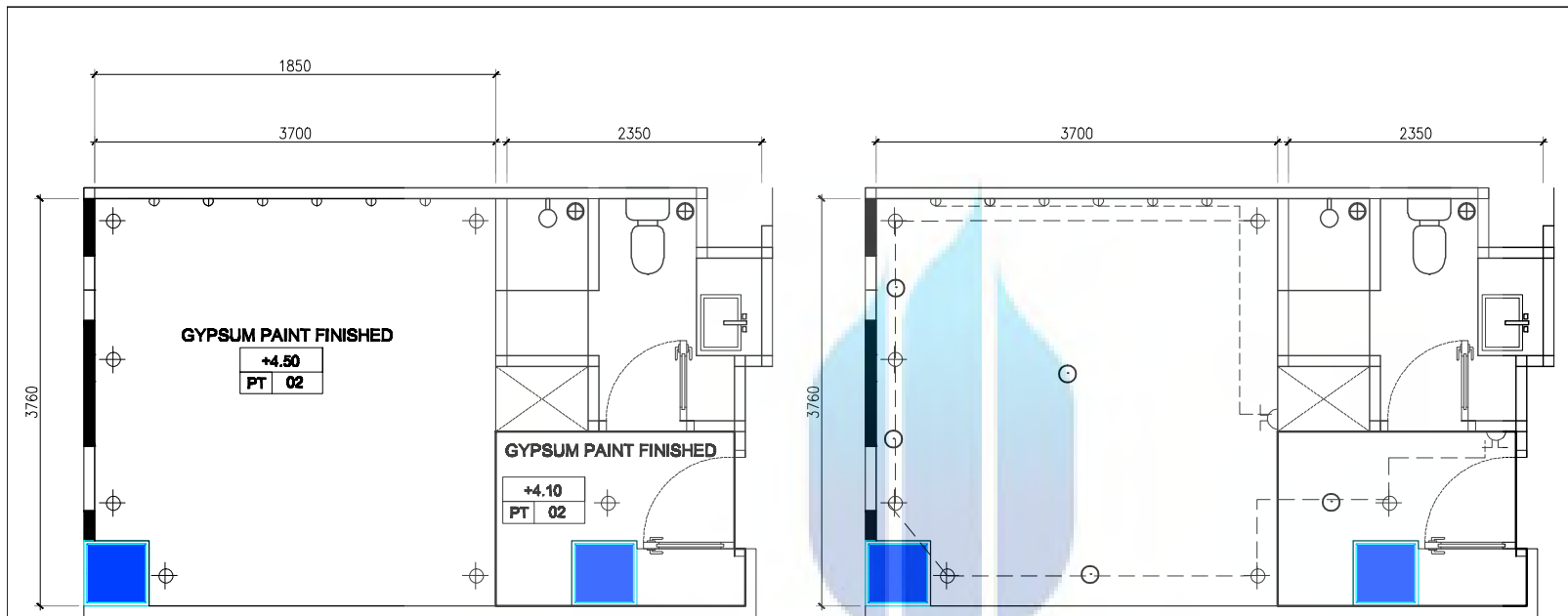

08 LAY OUT CEILING PLAN STANDAR ROOM
ID.SW.3.3 SCALE 1 : 100

08 LAY OUT ME STANDAR ROOM
ID.SW.3.4 SCALE 1 : 100

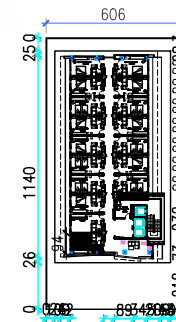
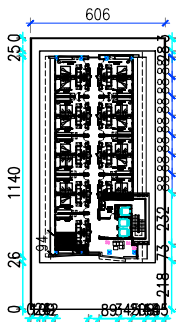

LEGEND

- ⊕ : Downlight 15 watt
- : Lampu gantung
- ⊙ : Sprinkler
- ⌞ : Solder
- - - : Kabel



NAMA PROYEK :
PERENCANAAN INTERIOR
SWASSEL HOTEL

JUDUL GAMBAR :
ME PLAN & CEILING PLAN
(STANDAR ROOM)

NAMA :
MARCIA CHRISYOLITA

NIM :
41715010040

DOSEN
PEMBIMBING :
YOHANES NUGROHO
UTOMO, Drs, M.ds

SKALA 1:100

JUMLAH GAMBAR	NOMOR GAMBAR
2 GAMBAR	ID.SW.3.3 ID.SW.3.4

NILAI **PARAF**



09 TAMPAK POTONGAN A-A' LOBBY
 ID.SW.1.5 SCALE 1 : 100

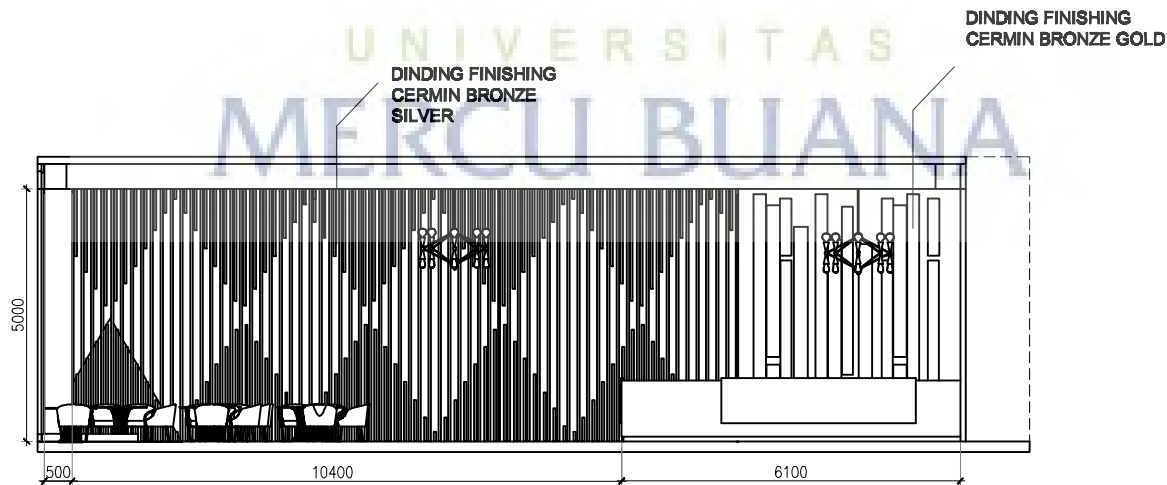

09 TAMPAK POTONGAN B-B' LOBBY
 ID.SW.1.6 SCALE 1 : 100

LEGEND



NAMA PROYEK :
PERENCANAAN INTERIOR
SWISSBELL HOTEL

JUDUL GAMBAR :
TAMPAK POTONGAN A-A'
& B-B'

NAMA:
MARCIA CHRISYOLITA

NIM:
41715010040

DOSEN
PEMBIMBING:
YOHANES NUGROHO
UTOMO, Drs, M.ds

SKALA 1: 100

JUMLAH GAMBAR

NOMOR GAMBAR

2 GAMBAR

ID.SW.1.5

ID.SW.1.6

NILAI

PARAF

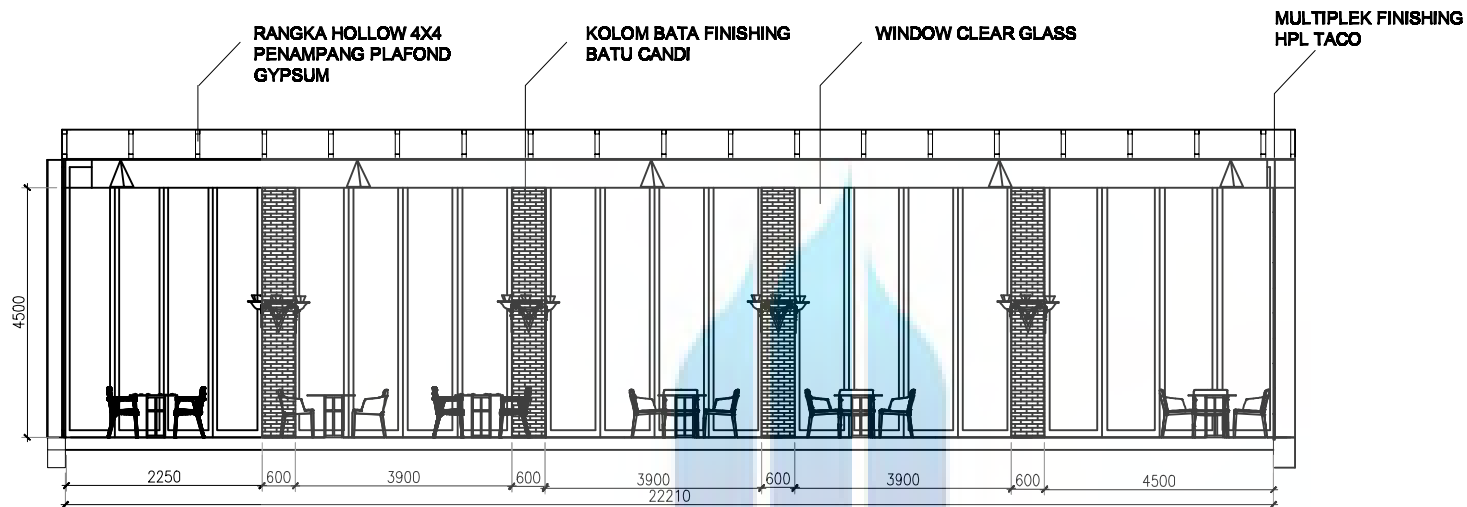

10 TAMPAK POTONGAN C-C' RESTAURANT
ID.SW.2.5 SCALE 1 : 100

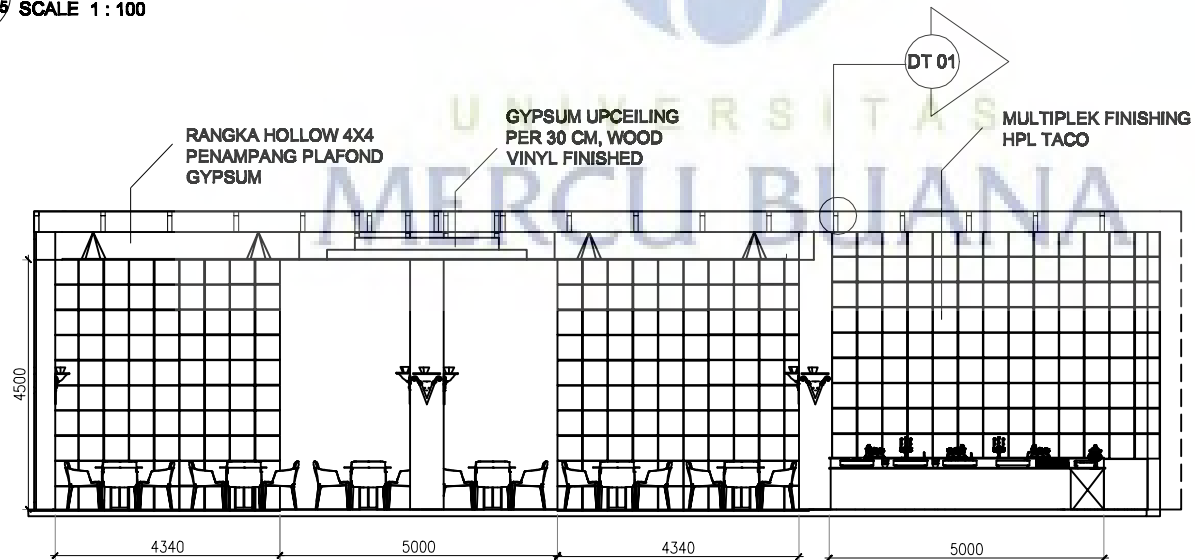

10 TAMPAK POTONGAN D-D' RESTAURANT
ID.SW.2.6 SCALE 1 : 100

LEGEND



NAMA PROYEK :
PERENCANAAN INTERIOR
SWISSBELL HOTEL

JUDUL GAMBAR :
TAMPAK POTONGAN C-C'
& D-D'

NAMA:
MARCIA CHRISYOLITA

NIM:
41715010040

DOSEN
PEMBIMBING:
YOHANES NUGROHO
UTOMO, Drs, M.ds

SKALA 1: 100

JUMLAH GAMBAR

NOMOR GAMBAR

2 GAMBAR

ID.SW.2.5

ID.SW.2.6

NILAI

PARAF

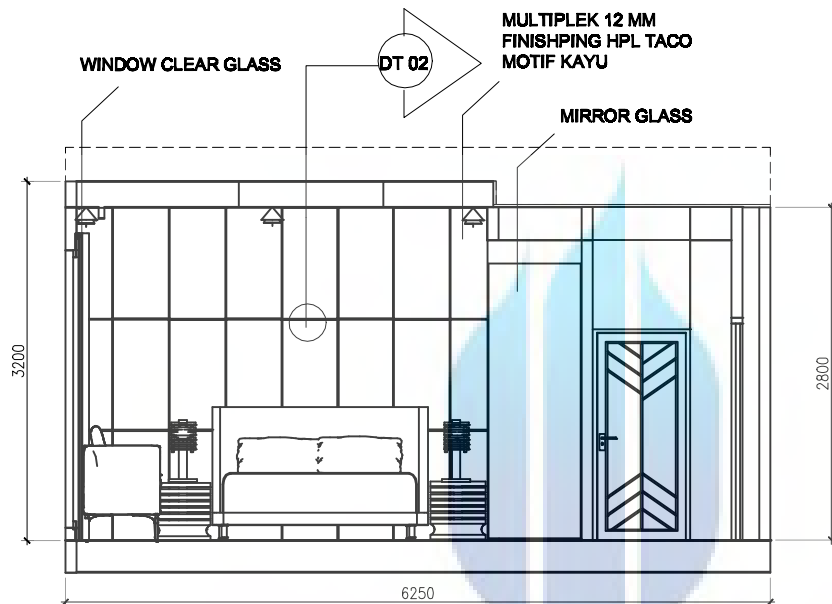

11 TAMPAK POTONGAN E-E' STANDAR ROOM
ID.SW.3.5 SCALE 1 : 100



11 TAMPAK POTONGAN F-F' STANDAR ROOM
ID.SW.3.6 SCALE 1 : 100

LEGEND



NAMA PROYEK :
PERENCANAAN INTERIOR
SWISSBELL HOTEL

JUDUL GAMBAR :
TAMPAK POTONGAN E-E'
& F-F'

NAMA:
MARCIA CHRISYOLITA

NIM:
41715010040

DOSEN
PEMBIMBING:
YOHANES NUGROHO
UTOMO, Drs, M.ds

SKALA 1: 100

JUMLAH GAMBAR	NOMOR GAMBAR
2 GAMBAR	ID.SW.3.5 ID.SW.3.6
NILAI	PARAF

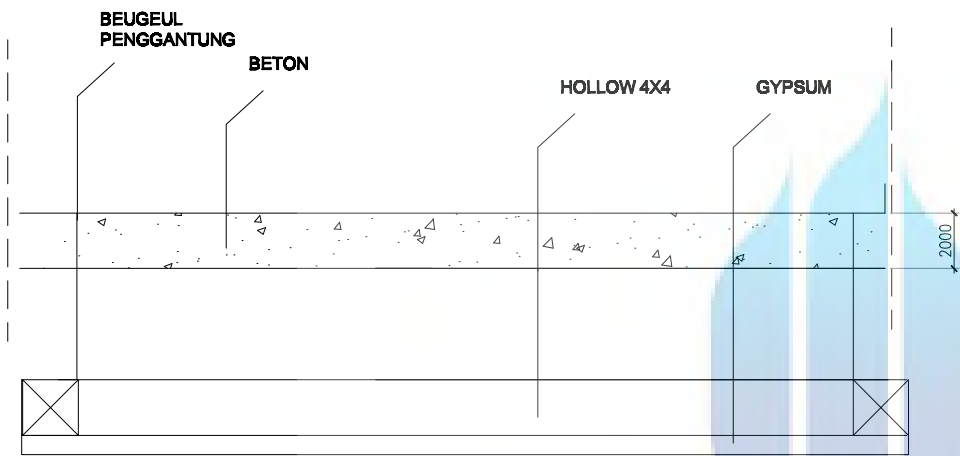

12
DT 01

DETAIL 1
SCALE 1 : 2

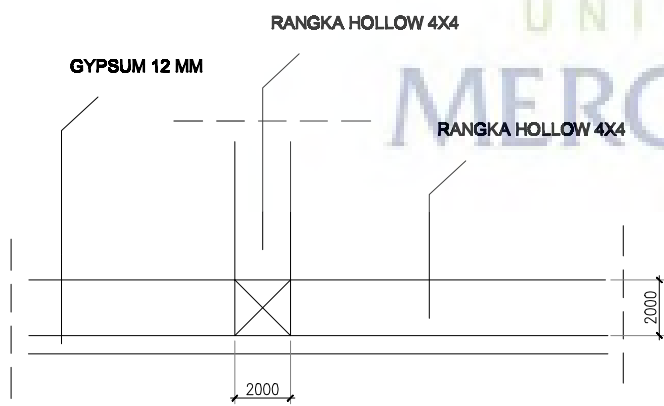

12
DT 01

DETAIL 1
SCALE 1 : 2

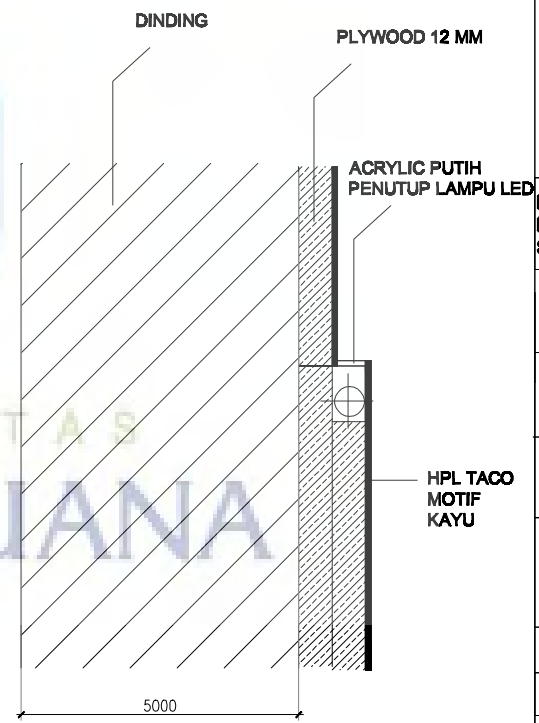

12
DT 02

DETAIL 2
SCALE 1 : 2

LEGEND



NAMA PROYEK :
PERENCANAAN INTERIOR
SWISSBELL HOTEL

JUDUL GAMBAR :
DETAIL ELEMEN INTERIOR

NAMA:
MARCIA CHRISYOLITA

NIM:
41715010040

**DOSEN
PEMBIMBING:**
YOHANES NUGROHO
UTOMO, Drs, M.ds

SKALA 1: 2

JUMLAH GAMBAR	NOMOR GAMBAR
2 GAMBAR	DT 01 DT 02

NILAI **PARAF**

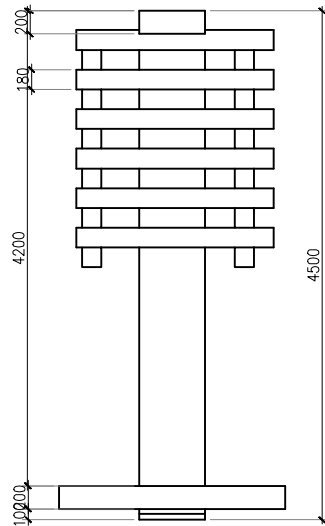

13 TAMPAK DEPAN LAMPU NAKAS
ID.SW.4.1 SCALE 1:2

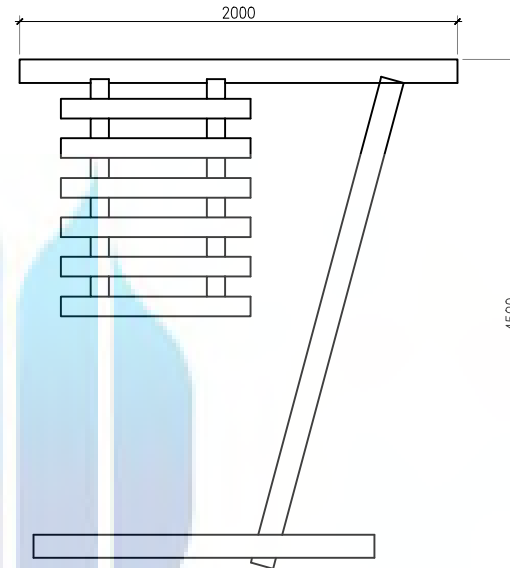

13 TAMPAK SAMPING LAMPU NAKAS
ID.SW.4.2 SCALE 1:2

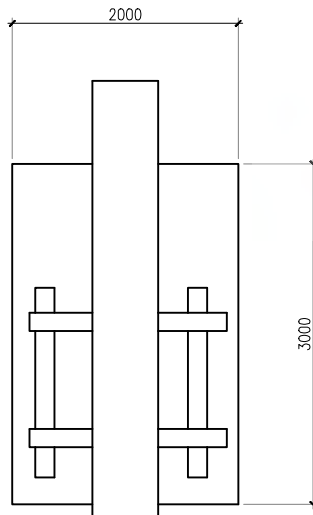

13 TAMPAK ATAS LAMPU NAKAS
ID.SW.4.3 SCALE 1:2

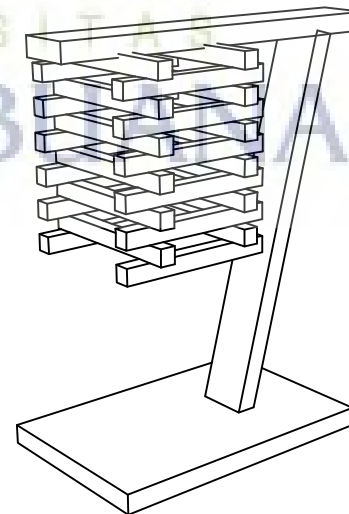

13 PERSPEKTIF LAMPU NAKAS
ID.SW.4.4 SCALE 1:2

LEGEND



NAMA PROYEK :
PERENCANAAN INTERIOR
SWISSBELL HOTEL

JUDUL GAMBAR :
GAMBAR KERJA
LAMPU NAKAS

NAMA:
MARCIA CHRISYOLITA

NIM:
41715010040

DOSEN
PEMBIMBING:
YOHANES NUGROHO
UTOMO, Drs, M.ds

SKALA 1:2

JUMLAH GAMBAR	NOMOR GAMBAR
4 GAMBAR	ID.SW.4.1 ID.SW.4.2 ID.S.W.4.3 ID.SW.4.4

NILAI	PARAF

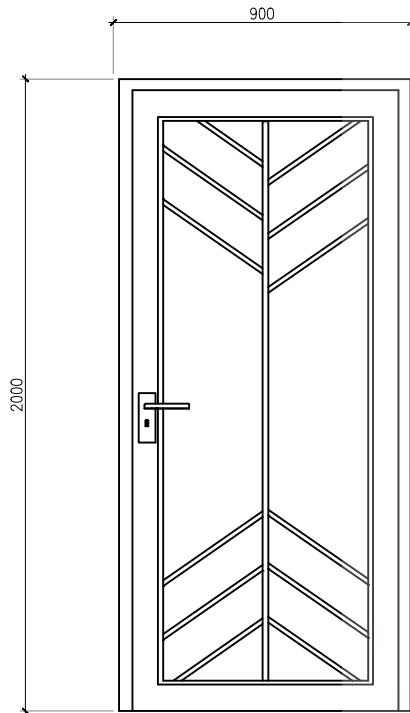

14 TAMPAK DEPAN PINTU
ID.SW.5.1 SCALE 1:2

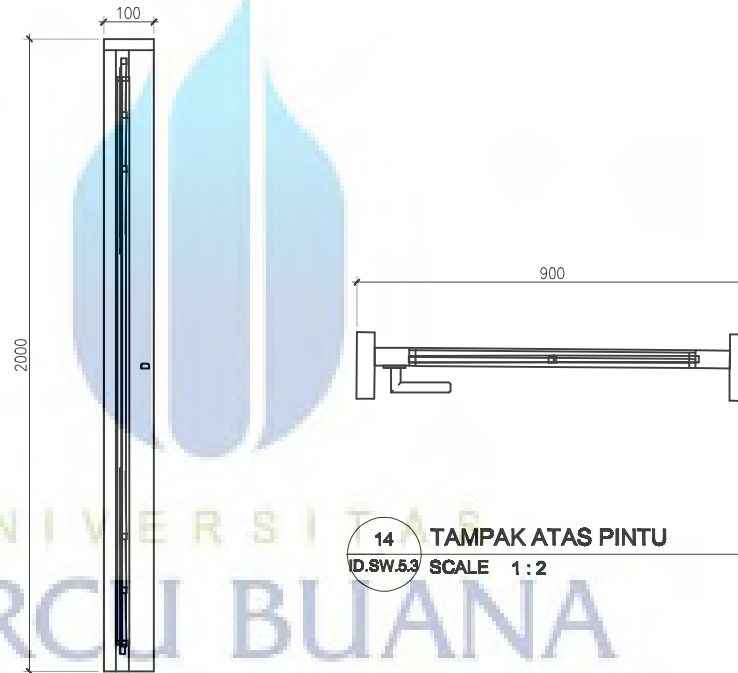

14 TAMPAK ATAS PINTU
ID.SW.5.3 SCALE 1:2

14 TAMPAK SAMPING PINTU
ID.SW.5.2 SCALE 1:2

LEGEND



NAMA PROYEK :
PERENCANAAN INTERIOR
SWISSBELL HOTEL

JUDUL GAMBAR :
GAMBAR KERJA PINTU

NAMA:
MARCIA CHRISYOLITA

NIM:
41715010040

**DOSEN
PEMBIMBING:**
YOHANES NUGROHO
UTOMO, Drs, M.ds

SKALA 1:2

JUMLAH GAMBAR	NOMOR GAMBAR
3 GAMBAR	ID.SW.5.1 ID.SW.5.2 ID.S.W.5.3
NILAI	PARAF

GAMBAR LAMPIRAN 3D

1. Lobby & Lounge Area
 - a. Axonometri Lobby & Lounge Area

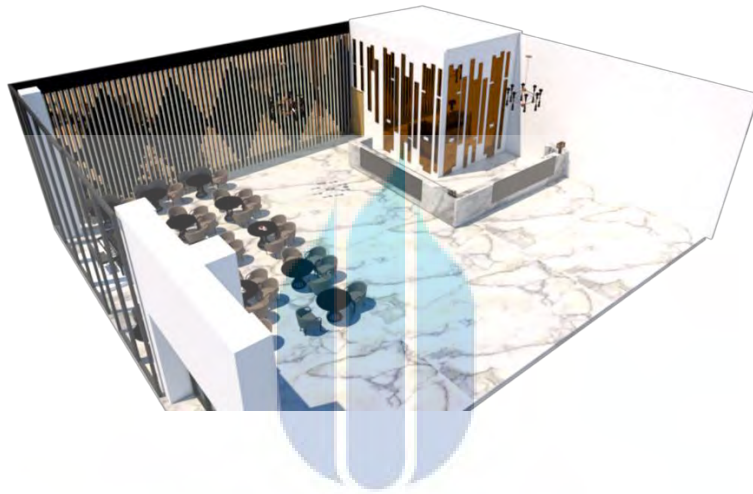

- b. Tampak Lobby & Lounge Area



Tampak 1

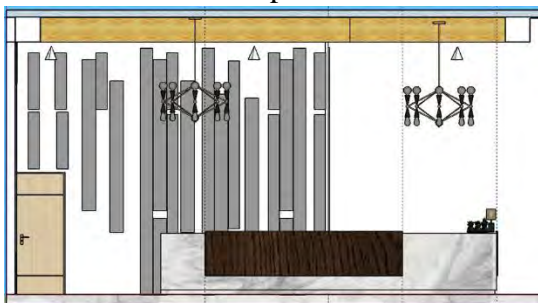

Tampak 2

c. Perspektif Lobby & Lounge Area



Perspektif 1



Perspektif 2

2. Restaurant Area

a. Axonometri Restaurant Area

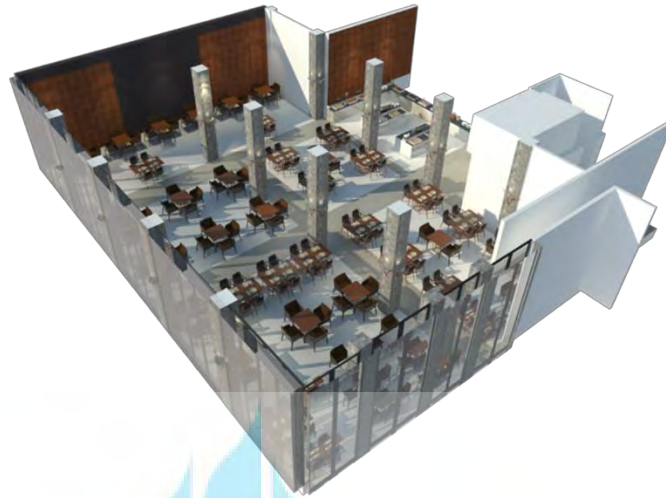

b. Tampak Restaurant Area



Tampak 1

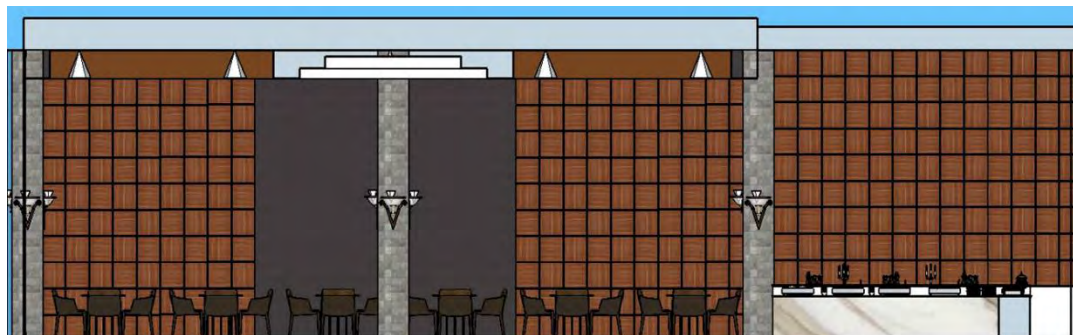

Tampak 2

c. Perspektif Restaurant Area



Perspektif 1



Perspektif 2

- 3. Standar Room
 - a. Axonometri Standar Room



- b. Tampak Standar Room



Tampak 1



Tampak 2

c. Perspektif Standar Room



Perspektif 1



Perspektif 2



UNIVERSITAS
MERCU BUANA

KARTU ASISTENSI FDSK

NAMA : Marcia Chrysolita
NIM : 41715010040
FAK/JUR : FDSK / Desain Interior

MATA KULIAH :
SMT/THN.AKAD :
DOSEN :

Tugas Akhir
8 / 20
Yohanes Nugroho, Dst, M.D.

NO	TGL	KETERANGAN	PARAF	NO	TGL	KETERANGAN	PARAF
1	Senin 11/19 /3	Asistensi penulisan judul Penulisan daffor li - Kelengkapan data proyek - Melanjutkan Bab 2-3					
2	Senin 18/19 /3	Lengkapi mind mapping Akses fokus pada volume & solusi Ecogreen pembahasan sesuai freem					
3	Senin 29/19 /3	Asistensi Bab 3 - Akses diperbaiki					
4	Senin /4/19	Asistensi Pro Layout - Asistensi Bab 4					
5	Senin /4/19	- Asistensi Konsep - Konsep furniture					
6	Senin /5/19	- Bab 4 perbaiki Konsep - Gambar kerja					
	Senin /10	- Asistensi Gambar kerja Layout lantai, dinding, plafond					
	Senin /6/19	- Gambar 3D perspektif Persepsi literatur Dan pengaliran view					
	Senin /7/19	Asistensi kereluruhan Gambar kerja Skripsi Konsep 3D Perspektif					

 <p>UNIVERSITAS MERCU BUANA</p>	<p>HASIL SIDANG STUDIO TUGAS AKHIR PROGRAM STUDI S1 DESAIN INTERIOR FAKULTAS DESAIN DAN SENI KREATIF UNIVERSITAS MERCU BUANA</p>	Q
--	---	----------

No. Dokumen	010 423 4 48 00	Distribusi					
Tgl. Efektif	7 MARET 2005						



Berdasarkan hasil Sidang Studio II Tugas Akhir Semester Genap Tahun Akademik 2018/2019 pada tanggal 16 Juli 2019, maka mahasiswa berikut ini :

Nama : Marcia Chrisyolita
 NIM : 41715010040
 Judul TA : Perancangan Desain Interior Pada Business Hotel Swiss Bell
 Pembimbing : Nugroho Utomo, Drs., M.Ds

dinyatakan :

- Lulus Langsung, dengan nilai
 Lulus Melengkapi, dengan nilai **80,564 A**
 Perbaikan
 Tidak Lulus

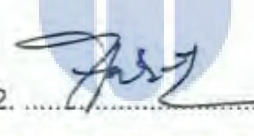
Ketua dan Anggota Dewan Penguji :

1. 
 2. 
 3. 

UNIVERSITAS

LEMBAR PENGESAHAN MELENGKAPI/PERBAIKAN

(Lembar Pengesahan TUGAS AKHIR Melengkapi/Perbaikan ini ditanda tangani apabila mahasiswa telah melengkapi/memperbaiki seminar sesuai catatan Dewan Penguji pada saat Sidang Tugas Akhir)

Pembimbing/Ketua Sidang/Penguji I

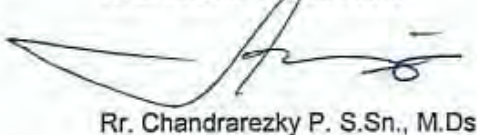

Koordinator Tugas Akhir

 Rr. Chandrarezky P. S.Sn., M.Ds

Penguji II

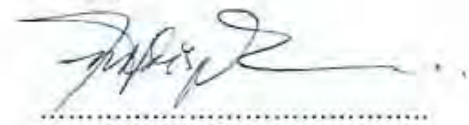

Penguji III

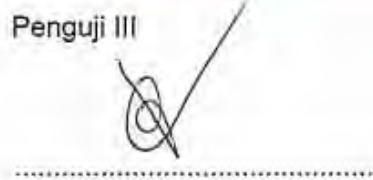

Catatan :

- Lembar Pengesahan ini harus ditanda tangani oleh Pembimbing, Penguji dan Ketua Sidang pada Laporan yang telah dilengkapi/diperbaiki dikumpulkan.
- Jadwal pengumpulan **SIDANG Melengkapi** tanggal **(1 Minggu Setelah Tanggal Sidang)** maksimum jam 16.00 WIB. Jadwal pengumpulan Tugas Akhir **Perbaikan** tanggal **(2 Minggu Setelah Tanggal Sidang)** maksimum jam 16.00 WIB.
- Apabila mahasiswa tidak memasukkan Melengkapi/Perbaikan sesuai jadwal yang telah ditetapkan, maka status kelulusannya diturunkan satu tingkat ke bawah.