

DAFTAR PUSTAKA

1. J.F. Douglas. "*Solving Problems in Fluid Mechanics*". Longman, Singapore. 1986.
2. Robert L. Daugherty, AB, M.E. "*Fluid Mechanics with Engineering Applications*". MC Graw-Hill Book Company. Singapore. 1989.
3. Sears. Zemansky. "*Fisika Untuk Universitas I*". Binacipta. Jakarta. 1991.
4. Soekamto, Bambang , t.t. "*Hidrolika Mekanika Fluida*". Jakarta. Pusdiklat Garuda.1990.

LAMPIRAN



(Proses pengetesan Pompa Vakum)
(Sumber : GMF Aero Asia, Pneumatic Shop)



(Proses pengetesan Pompa Vakum)
(Sumber : GMF Aero Asia, Pneumatic Shop)



(Pompa Vakum dengan Motor Listrik)
(Sumber : GMF Aero Asia, Emergency Shop)

BAGIAN-BAGIAN PERANCANGAN POMPA VAKUM (*VACUUM PUMP*)



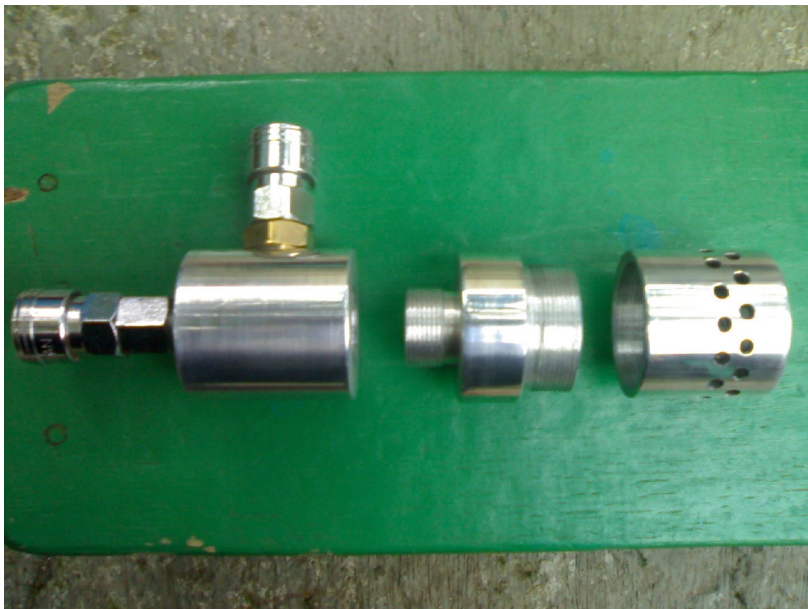
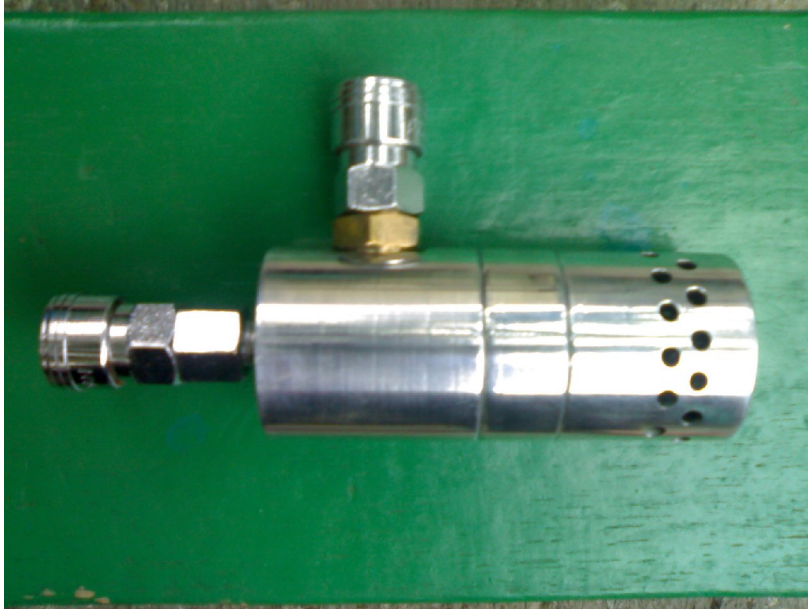

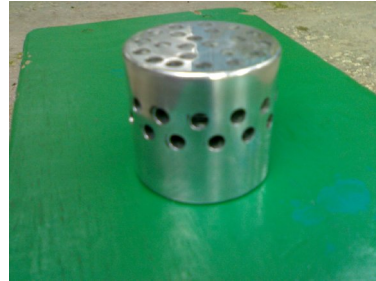

Umrechnungstafel für Druckeinheiten

| SI-Einheiten mit Ableitungen | | gesetzlich befristet zugelassene Einheiten | | | | | | | | | | | | | |
|---------------------------------|----------------------|---|--|----------------------|--|-----------------------------|----|--------------------------------|--------------------------------|--------------------|-----------------------------|---------------------------------|--------------------------------|--------------------------------|-------------------|
| bar | mbar | N/m ² | | kN/m ² | | mmHg (0° C) | | m H ₂ O (4° C) | kp/cm ² | | Inch Hg (0° C) | Inch H ₂ O (4° C) | PSI | | atm (standard) |
| | | Pa | | kPa | | Torr | at | | lb/in ² | lb/in ² | | | | | |
| 1 | 1000 | 1 · 10 ⁵ | | 100 | | 750,062 | | 10,197 2 | 1,019 72 | | 29,530 | 401,463 | 14,503 8 | 0,986 923 | |
| 1 · 10 ⁻³ | 1 | 100 | | 0,100 | | 0,750 062 | | 1,019 72 · 10 ⁻² | 1,019 72 · 10 ⁻³ | | 0,029 530 | 0,401 463 | 0,014 504 | 9,869 23 · 10 ⁻⁴ | |
| 1 · 10 ⁻⁵ | 1 · 10 ⁻² | 1 | | 1 · 10 ⁻³ | | 7,501 · 10 ⁻³ | | 1,019 72 · 10 ⁻⁴ | 1,019 72 · 10 ⁻⁵ | | 2,953 · 10 ⁻⁴ | 4,015 · 10 ⁻³ | 1,450 38 · 10 ⁻⁴ | 9,869 23 · 10 ⁻⁶ | |
| 1 · 10 ⁻² | 10 | 1000 | | 1 | | 7,501 | | 0,101 97 | 0,010 197 | | 0,295 3 | 4,015 | 0,145 038 | 9,869 23 · 10 ⁻³ | |
| 1,333 22 · 10 ⁻³ | 1,333 22 | 133,322 | | 0,133 322 | | 1 | | 1,359 51 · 10 ⁻² | 1,359 51 · 10 ⁻³ | | 0,039 370 | 0,535 240 | 0,019 337 | 1,315 79 · 10 ⁻³ | |
| 0,098 067 | 98,066 5 | 9,806 65 · 10 ³ | | 9,806 65 | | 73,555 9 | | 1 | 0,1 | | 2,895 9 | 39,370 1 | 1,422 33 | 0,096 784 | |
| 0,980 665 | 980,665 | 9,806 65 · 10 ⁴ | | 98,066 5 | | 735,559 | | 10 | 1 | | 28,959 | 393,701 | 14,223 3 | 0,967 841 | |
| 0,033 864 | 33,863 9 | 3386 | | 3,386 | | 25,4 | | 0,345 316 | 0,034 532 | | 1 | 13,595 1 | 0,491 154 | 0,033 421 | |
| 2,490 89 · 10 ⁻³ | 2,490 89 | 249,089 | | 0,249 089 | | 1,868 32 | | 2,540 · 10 ⁻² | 2,540 · 10 ⁻³ | | 0,073 556 | 1 | 0,036 13 | 2,458 · 10 ⁻³ | |
| 0,068 95 | 68,947 6 | 6 894,76 | | 6 894,76 | | 51,714 9 | | 0,703 07 | 0,070 307 | | 2,036 02 | 27,68 | 1 | 0,068 046 | |
| 1,013 25 | 1013,25 | 1,013 25 · 10 ⁵ | | 1,013 25 | | 760 | | 10,332 3 | 1,033 23 | | 29,921 | 406,78 | 14,695 9 | 1 | |

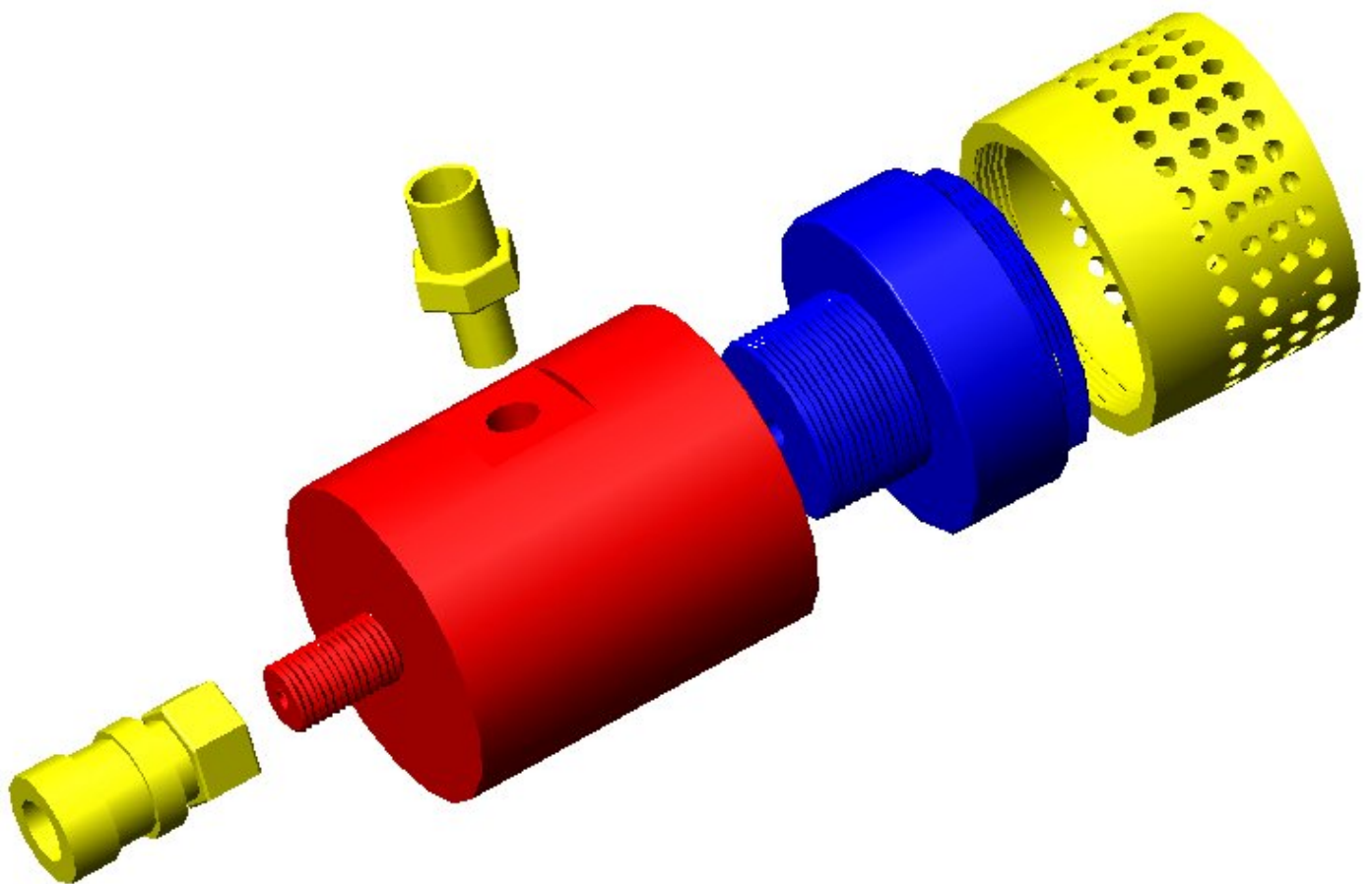

| Jumlah | | | Nama Bagian | No. Bag | Bahan | Ukuran | | Keterangan | |
|--------|----|---|-------------------|---------|-------|-------------|----------|------------|-------|
| III | II | I | Perubahan | | | Satuan | | | |
| | | | | | | mm | | | |
| | | | VACUM PUMP | | | Skala | Digambar | BUDLP | |
| | | | | | | | | | Skala |
| | | | UNIV. MERCU BUANA | | | DRAW TA-001 | | A4 | |